



















CAIS CANTILEVER S

CANTILEVER S	mm; kg	mm; kg	mm; kg	mm; kg	mm; kg	mm; kg	mm; kg	mm; kg
A	3000	3200	3400	3600	3800	4000	4200	4500
max. weight gate	325 kg	325 kg	325 kg	350 kg	375 kg	400 kg	425 kg	450 kg
B	900	960	1020	1080	1140	1200	1260	1350
C	1440	1500	1560	1620	1680	1740	1800	1890
D	270	270	270	270	270	270	270	270

-  EASY ASSEMBLING
-  C 2 HQ BEARINGS
-  FAST NO WELDING
-  CARRIAGES CENTER HOLES MILLED NOT LASERED
-  15 BOLTS 15 RIVET NUTS INCLUDED (*)
-  MULTI RIVITED SECTIONS
-  «C» TRACK SERIAL NO. 100% COMPATIBILITY CARRIAGE TESTED
-  JAPANESE ROBOTICS FANUC
-  GERMAN STEEL WUPPERMANN
-  UNIVERSITY OF TECHNOLOGY – BRNO
-  HOT DIPPED GALVANIZED
-  - 37°C TESTED & PROVEN
-  ARROW STRAIGHT «C» TRACK
-  + 50°C TESTED & PROVEN
-  BUILD IN FLYING HOLE PUNCH – EVERY 400 mm
-  NO WELDING NEEDED
-  GALVANIZED INTERNAL EDGES
-  MADE IN CZECH REPUBLIC

$$B = 0,3 \times A$$

$$L = A + B + (2 \times D) + E$$

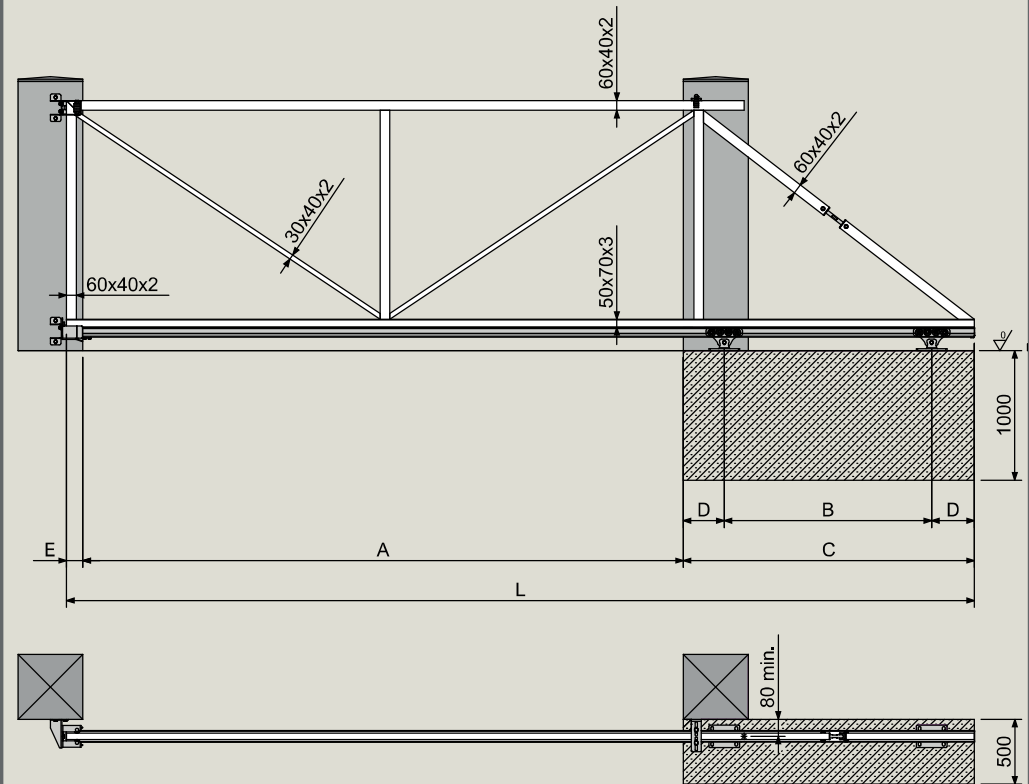
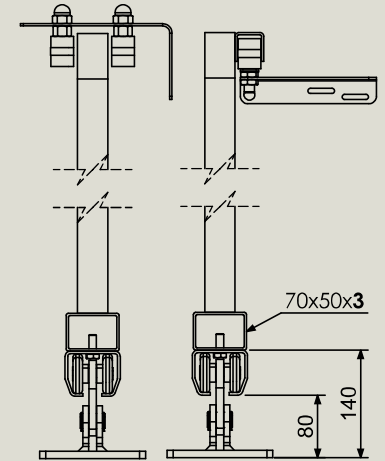

(*) ONLY SETS